



**Firestop
Centre**
Innovative Firestop Solutions

System FC517

Penetration Detail: Blank Aperture
up to 40mm fire-stopped with
FIRESTOP Ultra Sealant

Separating Element: Min. 116mm thick
FR Plasterboard (2 x 13mm) or Concrete
Wall

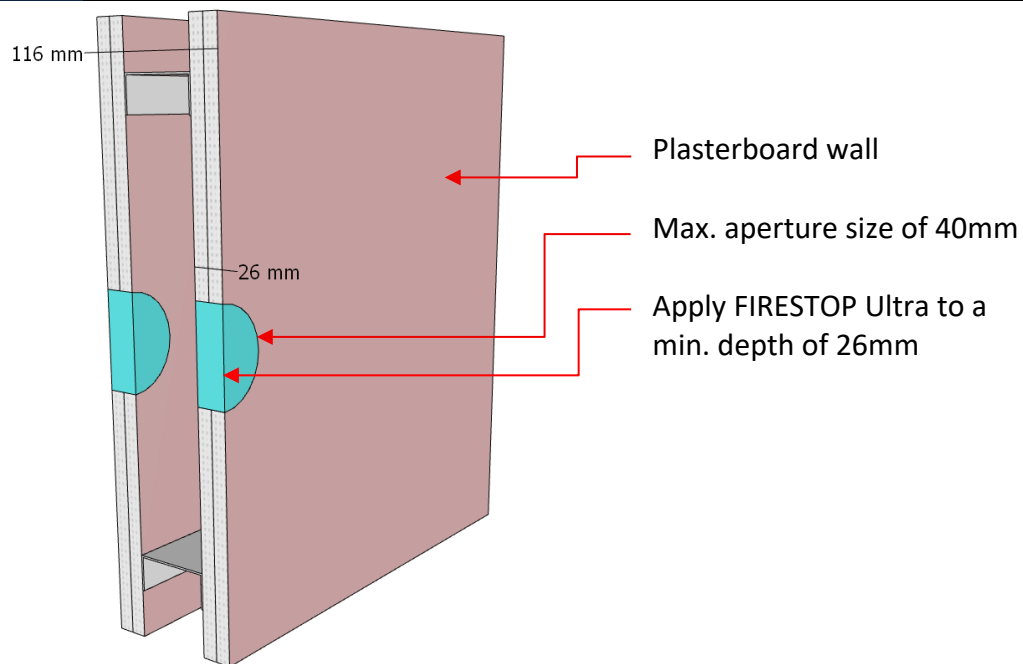

Installation Instructions:

1. Ensure surfaces are free of grease or other contaminants.
2. Apply FIRESTOP Ultra to the full depth of the plasterboard (nominal 26mm) on both sides, finished flush with the plasterboard face.

Services & Ratings (FRR)

Blank Aperture Size	Sealant Depth	FRR
40mm	26mm	-/120/120

- **FIRESTOP Ultra** is suitable for both interior and exterior applications - refer to the *FIRESTOP Ultra UV-Adhesion Report* for details.

Compliance

Report	Fire TS Lab Report RIR2207601
Pages	4 & 17
Standards	AS1530.4-2014 & AS4072.1-2005

Firestop Centre Technical support:
Tel: +64 9 483 4000
info@firestopcentre.co.nz
www.firestopcentre.co.nz

Drawing Rev: 1.0

Scale: NTS

Disclaimer: Firestop Centre may change product specifications without notice as part of our ongoing development and testing. All information in this document is provided in good faith and for guidance only. All drawings are for illustration purposes only and may not reflect the actual product. Since we cannot control how the product is installed or the conditions on-site, we do not guarantee the product's performance. We also accept no responsibility for any loss, damage, or injury resulting from the use of this information.